

Assembly instructions

PO531 PO533 PO534 PO535 Tension Fabric Display Monolith



The contents of the package:

- Textile carry bag: 1 piece
- Textile graphic: 1 piece
- PopUp frame including one metal base, several aluminium tubes and one screws bag: 1 piece.

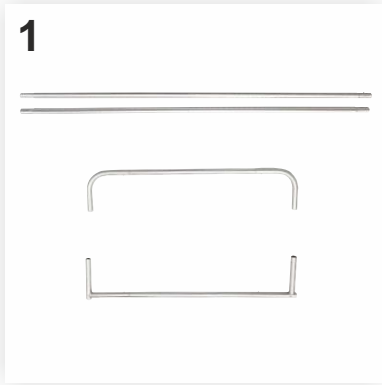

1-3. First join the aluminium tubes connected by elastic to form the vertical support bars of the PopUp. Join the two rounded corner elements with one of the two short tubes in the package. Then join the two straight corner elements with one of the two short tubes in the package. In order to join the corner elements with the short tubes, press the button on one of the tubes and push one tube toward the other provided with an orifice, as shown in Figure 2. When combined correctly, a "click" will be heard and the button will come out through the orifice, as in Figure 3.

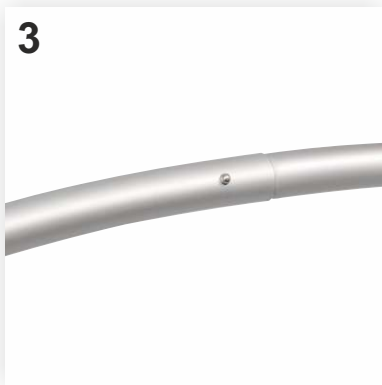

4. In the end you will get: two straight bars (for the vertical sides) and two shorter bars with the corner elements mounted (for the horizontal sides).

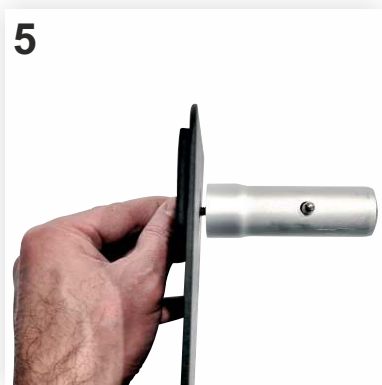

5-6. Mount the short ends on the metal base using the two screws from bag. At this stage, let the screws loosen and tighten them completely in step 7.

The pictures are for presentation only; your product can be slightly different!

Assembly instructions

PO531 PO533 PO534 PO535 Tension Fabric Display Monolith



7



8

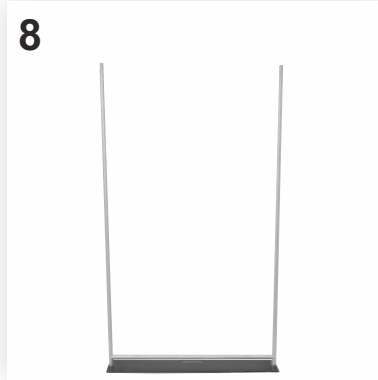

7. Applying the same method as in pictures 2-3, join the horizontal side (with the straight corner elements) with the two short ends mounted in step 5-6. If necessary, press firmly until fully inserted. Then completely tighten the screws using the screwdriver in the screw bag.

8. To the system thus formed, add the two long vertical bars.

9



10



9. Add the second horizontal bar at the top so that you'll get a complete frame. Now the structure is assembled.

10. To add the textile graphic, you need to undo its zipper. Then insert the graphic on the structure through the top, as in the adjacent picture.

11



11. Make sure you stretch well the customization and then close the zipper located at the bottom. Mounted correctly, the customization will be slightly tense and wrinkles-free.

Now the system Tension Fabric Display Monolith is assembled.

The pictures are for presentation only; your product can be slightly different!